

OCEAN PATRIOT

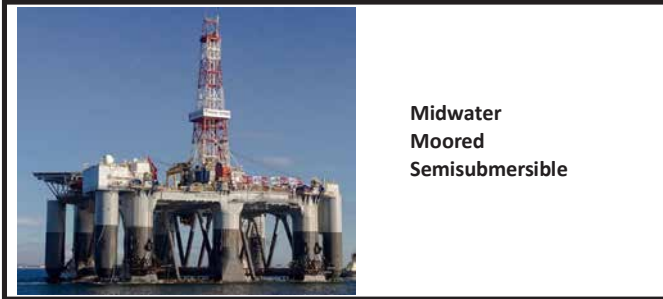

**Midwater
Moored
Semisubmersible**

STORAGE CAPACITY

Liquid Mud	2,288 bbls	364 m ³
Mud Storage Tanks	2x 1,000 bbls	2x 159 m ³
Base Oil	2,072 bbls	329 m ³
Brine	2,227 bbls	354 m ³
Bulk Barite/Gel	6,710 ft ³	190 m ³
Bulk Cement	10,000 ft ³	283 m ³
Sack Storage	270T	135 m ³
Fuel	13,020 bbls	2,070 m ³
Drill Water	6,711 bbls	1,067 m ³
Potable Water	2,861 bbls	455 m ³

GENERAL DESCRIPTION

Design	Trosvik, Bingo 3000
Year Entered Service	1983
Classification	ABS, +A1 Column Stabilised Drilling Unit
Main Deck	246ft (75m) Long x 206.6ft (63m) Wide
Draft	77ft (23.5m) Drilling, 36ft (10m) Transit
Displacement	33,010MT
Variable Deck Load	3,500MT Drilling / 3500MT Transit
Transit Speed	4 knots
Water Depth	1,476ft (450m) - outfitted
Drilling Depth	20,000ft (6,096m)
Accommodation	120 people
Helideck	Sikorsky S-92, CAP 437 compliant + d rating

SUBSEA EQUIPMENT

Diverter	Regan KFDS-3 20" 500 psi diverter with 14" flow line
BOP Stack	Hydril 18 3/4" 15,000 psi five-ram preventer 2x Cameron DL 18 3/4" 10,000 psi annular preventers, APIS53 compliant
C&K Manifold	3-1/16", 15,000 psi
Marine Riser	NOV DTI, 50ft long per joint
Tensioners	12 x 80 kips Shaffer wireline riser tensioners. Total capacity 960 kips with 50 ft. of wire travel
Moonpool	20 ft. x 72 ft 1x 60T Auxiliary Cart

DRILLING EQUIPMENT

Derrick	Unite D'ingen 160, 185 ft high with 40ft x 40ft base, hook load capacity of 1,000kips
Drawworks	Oilwell E-3000, 2400hp
Compensator	NOV Shaffer 25-600 600 kips capacity with 25ft stroke
Rotary Table	Oilwell A-495, 49-1/2", 650ST
Top Drive	Varco TDS-8SA, 650T
Tubular Handling	2x Varco HT100 4" - 12" 1x Varco AR3200 Iron Roughneck 3-1/2" - 9-1/2"
Fingerboard Capacity	DP - 29,1760ft (216 Stds) 5-1/2" OD DC - 945ft (7 Stds) of 8" OD DC - 945ft (7 Stds) of 9" OD
Mud Pumps	3x National 12-P-160, 1,600hp, 5000psi
Shale Shakers	3x NOV VSM Multisizers

POWER GENERATION

Main Power	4x EMD diesel engines rated at 2000kW
Emergency Power	1x Caterpillar 3412D electric rated at 520kW

STATION KEEPING / PROPULSION SYSTEM

Mooring System	8x 3.25" x 5,200 ft. RQ4 chains 8x 12T Stevpris anchors
-----------------------	--

OTHER INFORMATION

Mud Recovery	Riserless Mud Recovery System
BOP Tethering	BOP anchor points
Coil / Wireline	Coiled Tubing Lifting Frame

CRANES

Deck Cranes	1x 50T Liebherr Bos 50/1500 with 142ft boom 1x 68T Seatrax s9028 with 140ft boom
Pipe Handling	1x PKM700T Knuckle Boom Crane

OCEAN PATRIOT

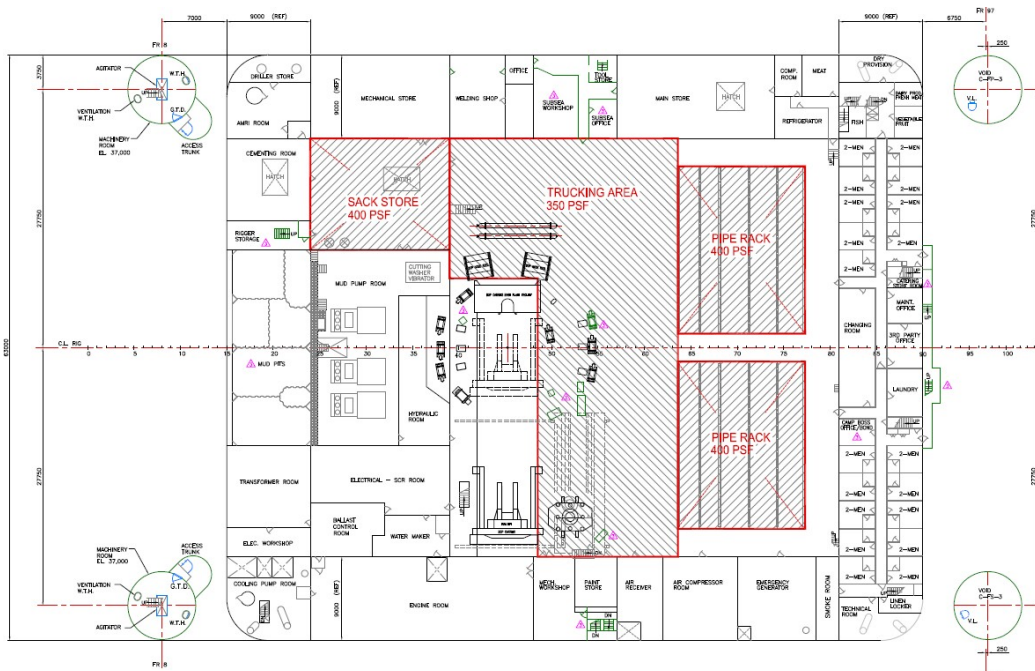
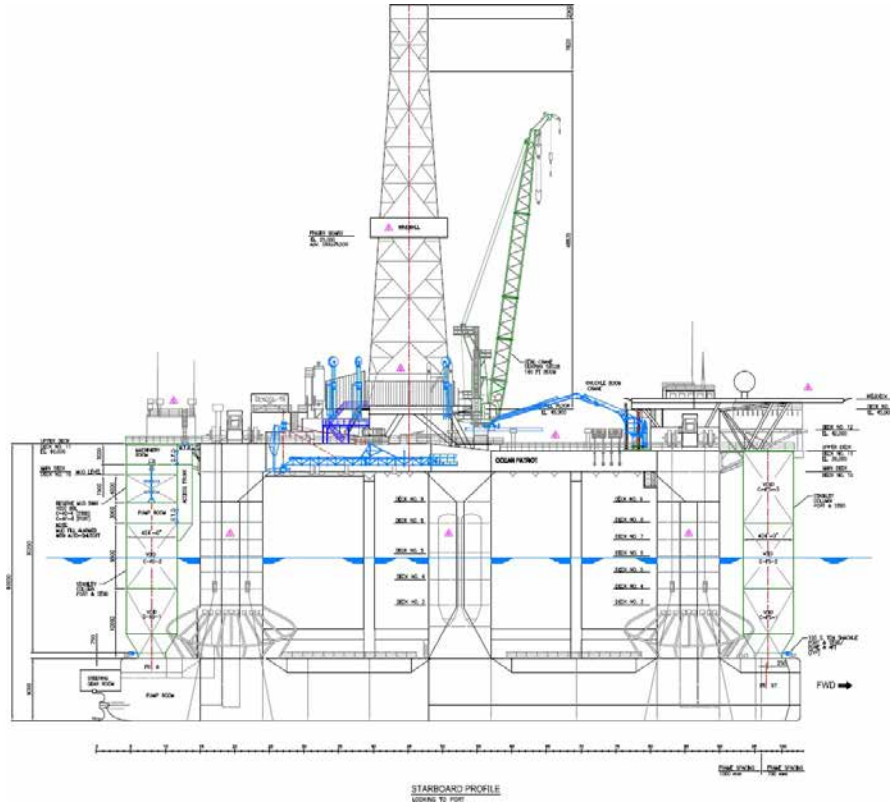

These specifications are intended for general reference purposes only. Actual equipment may vary upon the contract situation and customer needs.